

DREAM CURTAIN BATTERY MOTOR

191782

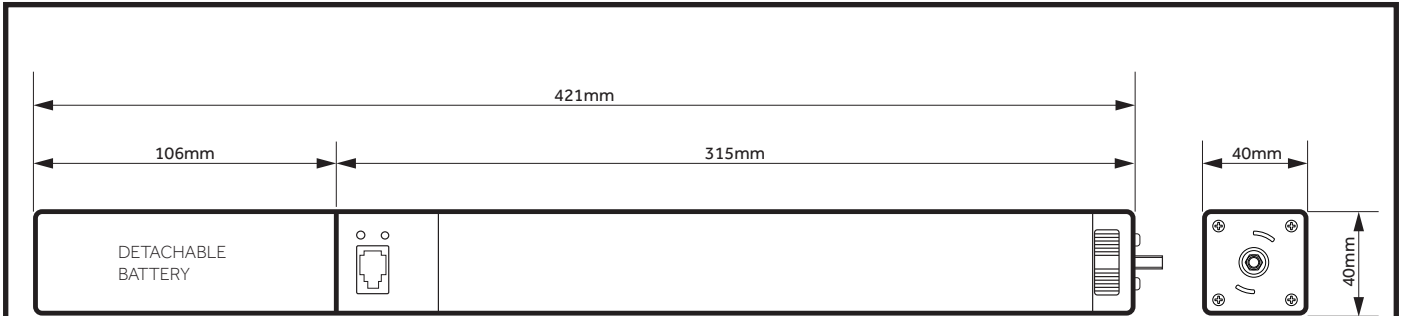

MOTOR SPECIFICATION

CONTROL TYPE	RADIO	RATED VOLTAGE	DC 14.8 V		
LIMITS	ELECTRONIC (set remotely)	IP RATING	IP40	RATED POWER	16 W
OUTPUT SPEED	20 cm/s	RATED CURRENT	1.0 A	MAX. LOAD	50 Kg
RATED TORQUE	1.2 N.m	RADIO FREQUENCY	433.92 MHz	MOTOR LENGTH	421 mm

USB-C

DREAM CURTAIN MOTOR FUNCTION BUTTONS

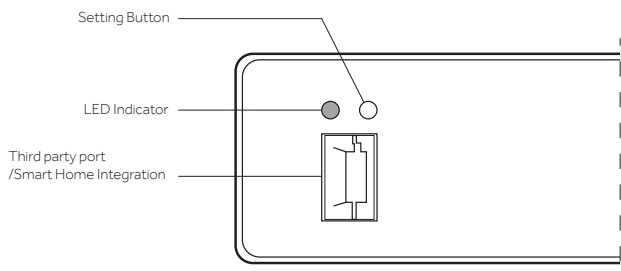

DREAM REMOTE FUNCTION BUTTONS

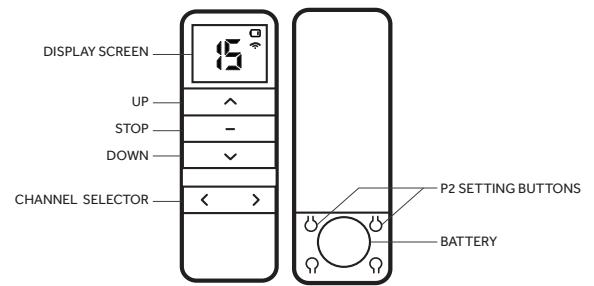

DREAM WALL SWITCH FUNCTION BUTTONS

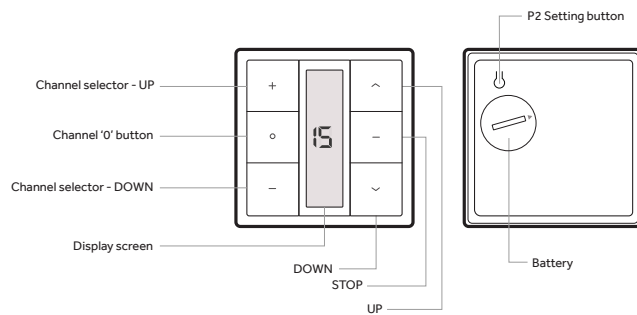

PROGRAMMING INSTRUCTIONS

Before starting the process of pairing a handheld remote/wall switch to a Dream motor, choose the channel to which it is to be paired. Channel Zero is reserved for simultaneously controlling all blinds paired to a remote and cannot be used for pairing, programming or other adjustments. If using a battery powered motor, ensure that it is sufficiently charged to complete the set-up process.

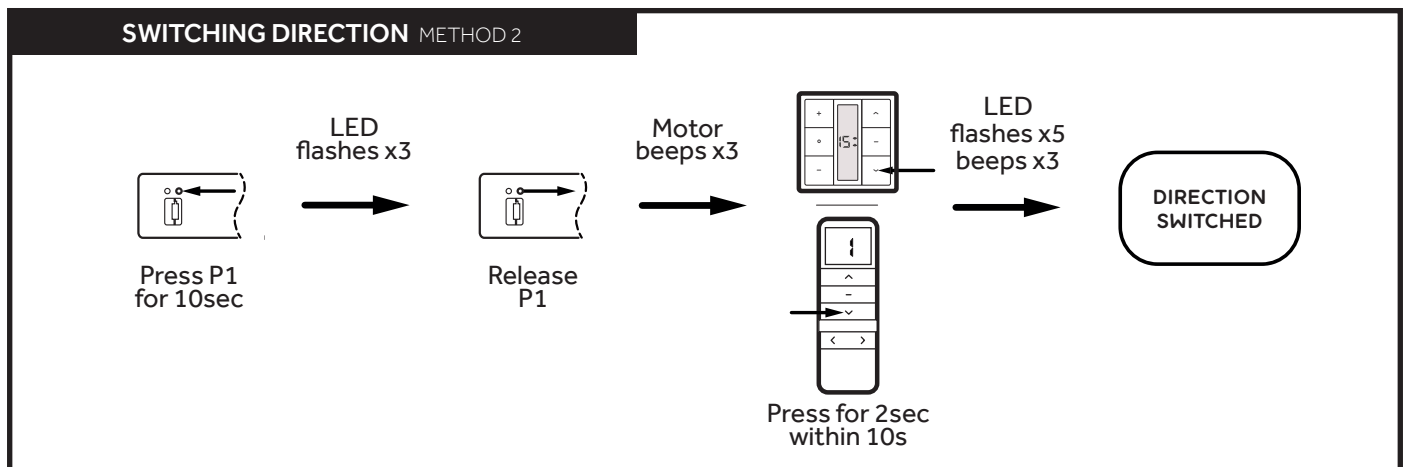
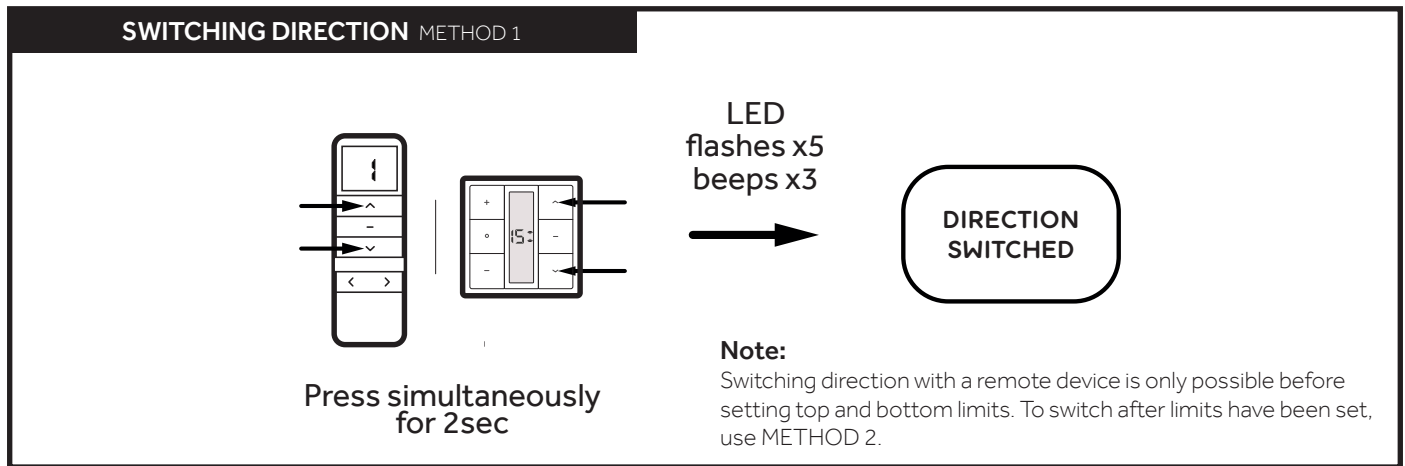
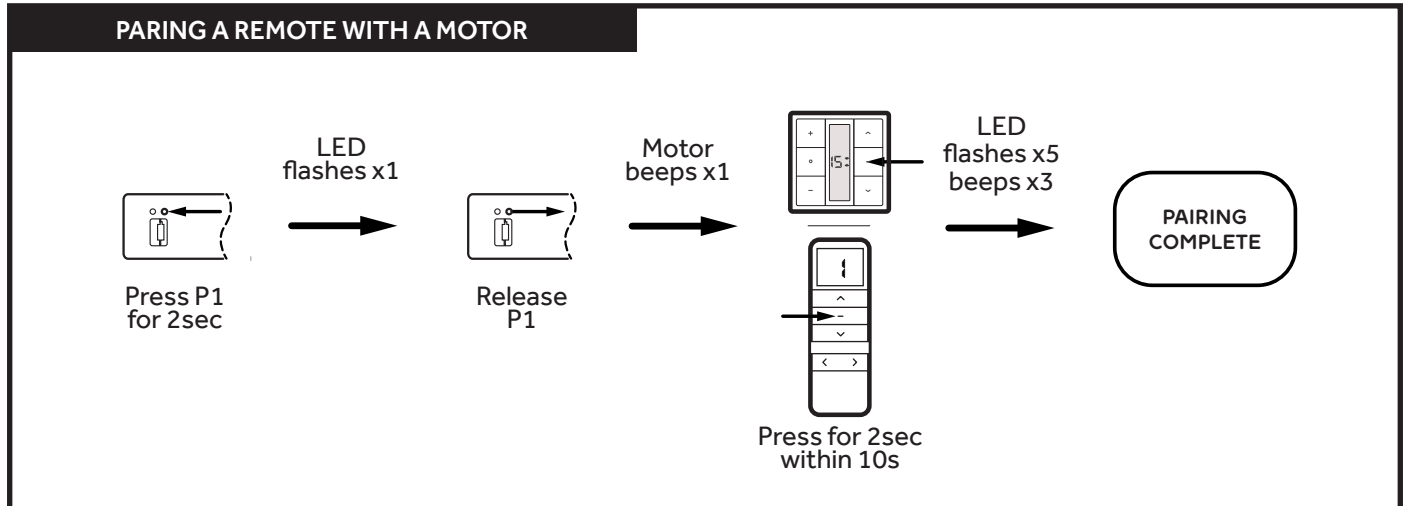

SETTING LIMITS

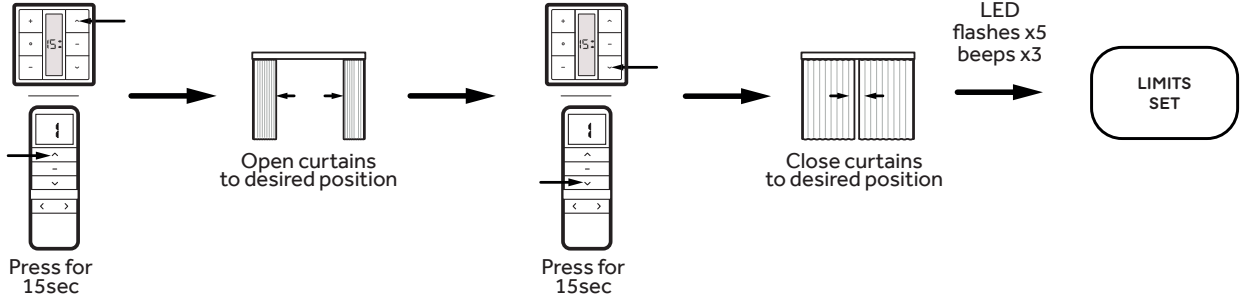

CLEARING LIMITS

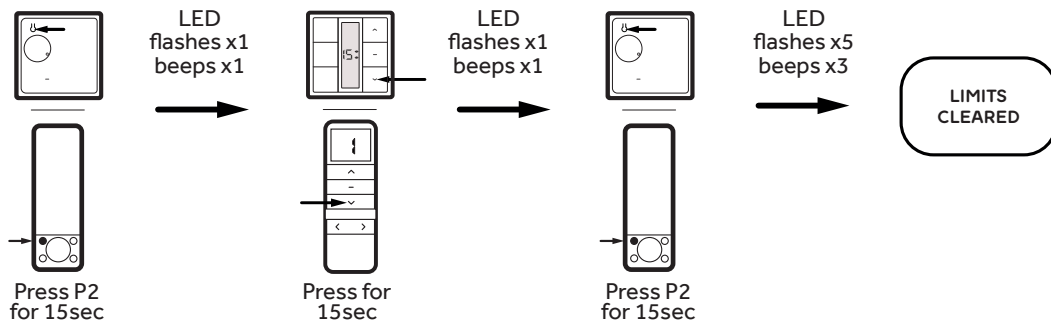

SETTING A FAVOURITE STOP POSITION

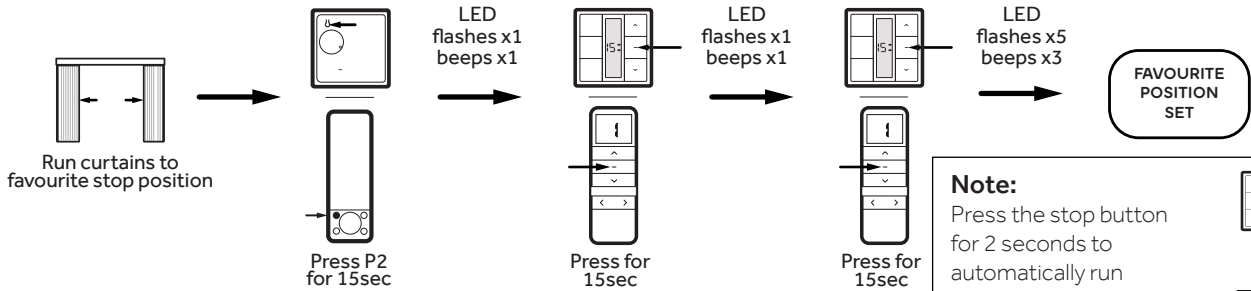

Note:
Press the stop button for 2 seconds to automatically run the curtains to a favourite stop position.

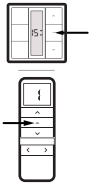

CLEARING A FAVOURITE STOP POSITION

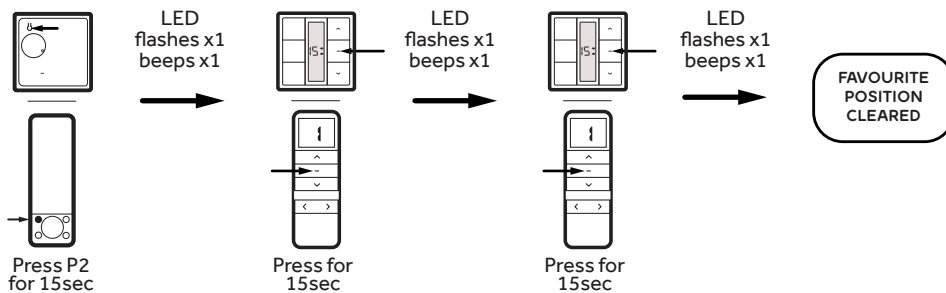

FINE-TUNING AN OPEN LIMIT

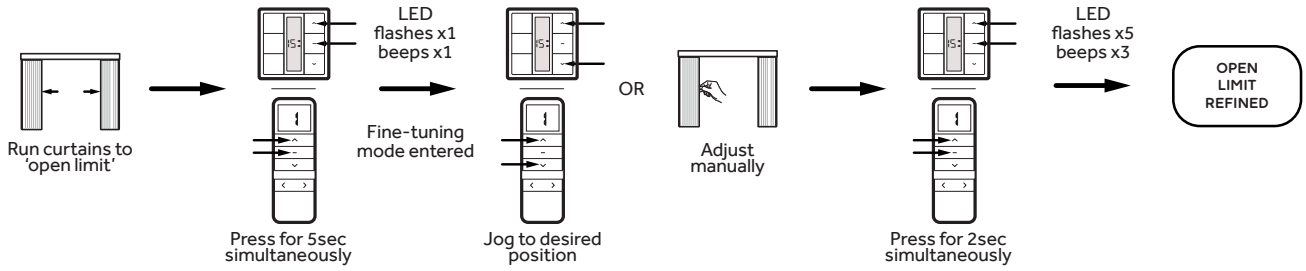

FINE-TUNING A CLOSED LIMIT

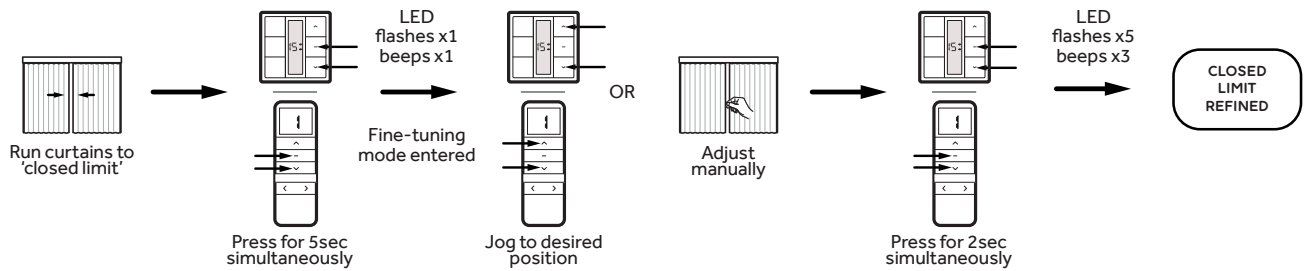

INCREASING MOTOR SPEED

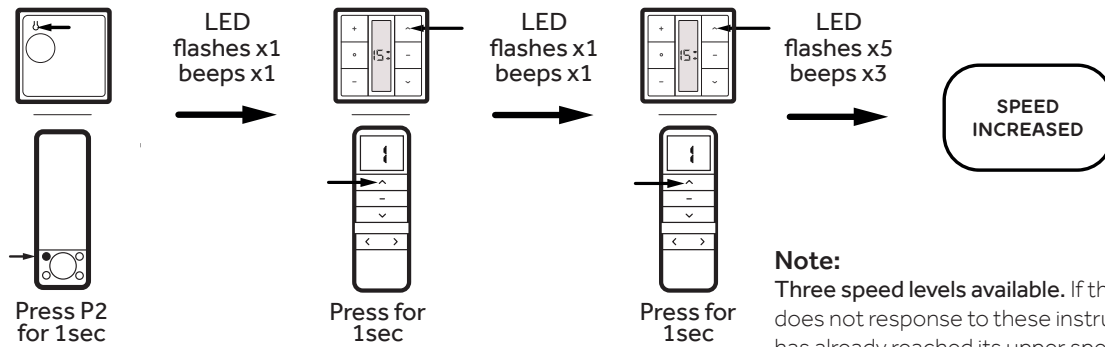

Note:

Three speed levels available. If the motor does not respond to these instructions, it has already reached its upper speed setting.

DECREASING MOTOR SPEED

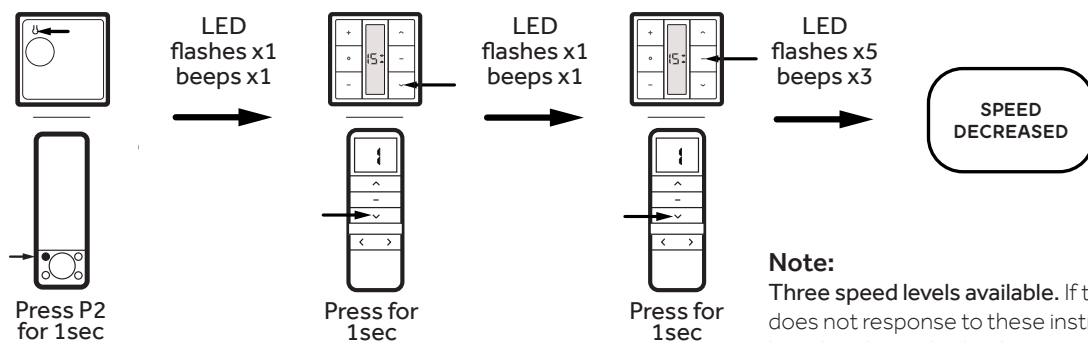

Note:

Three speed levels available. If the motor does not respond to these instructions, it has already reached its lower speed setting.

ACTIVATING/DEACTIVATING 'PULL TO START' CONTROL

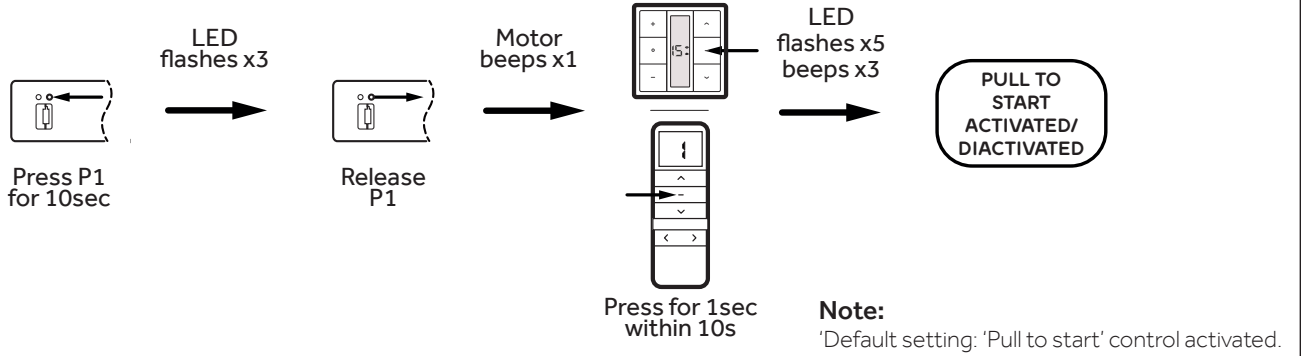

DEACTIVATING REMOTE CONTROL

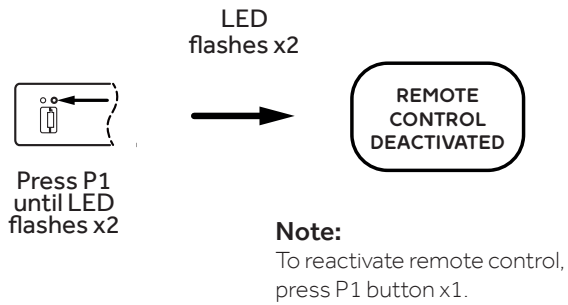

RESTORING FACTORY SETTINGS

